

# DRAWER BASE CABINETS SEI - 200 SERIES

**SEI - 210**

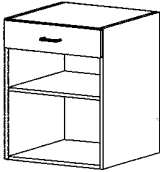

*Specify Face Height*  
*Interior Color*  
*Matches Exterior Color*  
*Shelves Adjustable*  
*or Fixed Shelves*  
*Spaced Equally*

**SEI - 220**

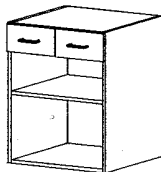

*Specify Face Height*  
*Drawers Divided Equally*  
*Interior Color*  
*Matches Exterior Color*  
*Shelves Adjustable*  
*or Fixed Shelves*  
*Spaced Equally*

**SEI - 211**

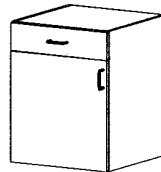

*Specify Face Height*  
*Shelves Adjustable*  
*or Fixed Shelves*  
*Spaced Equally*

**SEI - 221**

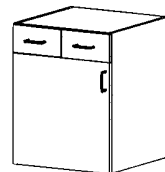

*Specify Face Height*  
*Drawers Divided Equally*  
*Shelves Adjustable*  
*or Fixed Shelves*  
*Spaced Equally*

**SEI - 212**

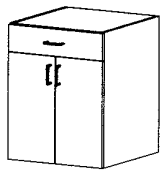

*Specify Face Height*  
*Shelves Adjustable*  
*or Fixed Shelves*  
*Spaced Equally*

**SEI - 222**

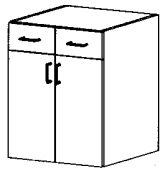

*Specify Face Height*  
*Drawers Divided Equally*  
*Shelves Adjustable*  
*or Fixed Shelves*  
*Spaced Equally*

**SEI - 276**

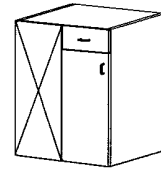

*Specify Face Height*  
*Specify Blind Width in Notes*  
*Shelves Adjustable*  
*or Fixed Shelves*  
*Spaced Equally*

**SEI - 223**

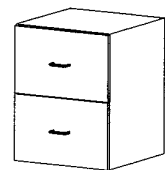

*Specify Face Heights*  
*4" rail between drawer faces*  
*upon request*

**SEI - 230**

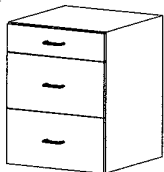

*Specify Face Heights*  
*4" rail between drawer faces*  
*upon request*

**SEI - 240**

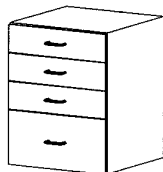

*Specify Face Heights*  
*4" rail between drawer faces*  
*upon request*

**SEI - 250**



*Specify Face Heights*  
*4" rail between drawer faces*  
*upon request*

**SEI - 260**

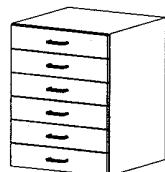

*Specify Face Heights*  
*4" rail between drawer faces*  
*upon request*

# DRAWER BASE CABINETS SEI - 200 SERIES

**SEI - 270**



*Specify Face Heights  
4" rail between drawer faces  
upon request*

**SEI - 233**

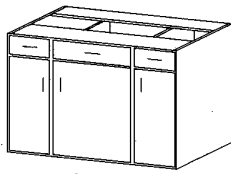

*Vanity Base  
2 Drawers  
3 Doors  
Specify Sink Width in notes  
Specify Face Height  
Shelves Adjustable  
or Fixed Shelves  
Spaced Equally*

**SEI - 234**

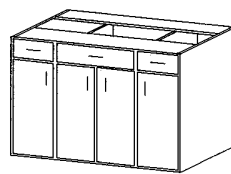

*Vanity Base  
2 Drawers  
4 Doors  
Specify Sink Width in notes  
Specify Face Height  
Shelves Adjustable  
or Fixed Shelves  
Spaced Equally*

**SEI - 251**

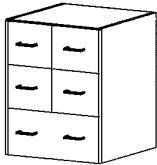

*Specify Face Heights*

**SEI - 261**

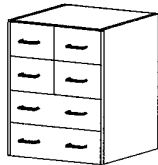

*Specify Face Heights*

**SEI  
291**

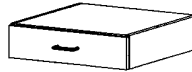

**SEI  
292**



*Drawers Divided Equally*

**SEI  
293**



*Drawers Divided Equally*